

WARRINGTON BOROUGH COUNCIL
TOWN AND COUNTRY PLANNING ACT 1990
VARIATION ORDER

**THE WARRINGTON BOROUGH COUNCIL (LAND ADJOINING WARRINGTON
ROAD AND GRANGE DRIVE PENKETH)
TREE PRESERVATION ORDER 1989**

The **WARRINGTON BOROUGH COUNCIL** ("the Authority") did on 23rd February 1989 make the above Tree Preservation Order ("the Order") pursuant to Section 198 and Section 201 of the Town and Country Planning Act 1990 ("the Act") the Order being subsequently confirmed by the Authority without modification on 9th August 1989.

The Authority now hereby varies the Order as shown in Schedule 1, which shall now be designated as The Warrington Borough Council (Land Adjoining Warrington Road and Grange Drive Penketh) Tree Preservation Order 2000.

Dated this 27th day of April 2000

The Common Seal of **WARRINGTON
BOROUGH COUNCIL** was hereunto
affixed in the presence of:-

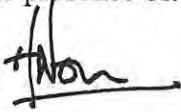

Solicitor to the Council

FIRST SCHEDULE

Trees Specified Individually (encircled in black on the map)

NO. ON MAP	DESCRIPTION	SITUATION
T1	Sycamore	Adjacent to the boundary of 52 Warrington Road

Area

None

Groups of Trees (within a broken black line on the map)

NO. ON MAP	DESCRIPTION	SITUATION
G1	Group of 1 Silver Birch, 1 Lime and 1 Sycamore	On the corner of Grange Drive and Warrington Road

Woodlands

None



THE WARRINGTON BOROUGH COUNCIL
 WARRINGTON ROAD/GRANGE DRIVE, PENKETH
 TREE PRESERVATION ORDER 2000



**WARRINGTON
BOROUGH
COUNCIL**

Name	
Dept.	Community Services
Ref.	
Date	9/3/2000
Scale	1:1,250

This map is reproduced from Ordnance Survey material with the permission of Ordnance Survey on behalf of the Controller of HMSO © Crown copyright. Unauthorised reproduction infringes Crown copyright & may lead to prosecution or civil proceedings. Warrington B.C. LA079898. Published.....



FIRST SCHEDULE

TREES SPECIFIED INDIVIDUALLY

(Encircled in black on the map)

No. on map
T1

<u>Description</u> Sycamore	<u>Situation</u> Adj. to the boundary of 52 Warrington Rd.
--------------------------------	---

TREES SPECIFIED BY REFERENCE TO AN AREA

None

GROUPS OF TREES

(Within a broken black line on the map)

NO. ON MAP

DESCRIPTION

SITUATION

~~G1~~

~~Group of 2 sycamore
and 1 holly~~

~~Adj. the boundary of
52 Warrington Road.~~

G2

Group of 1 silver birch
1 lime and 1 sycamore

On the corner of
Grange Drive and
Warrington Road

WOODLANDS

None

GS/KMB
25th November 1988



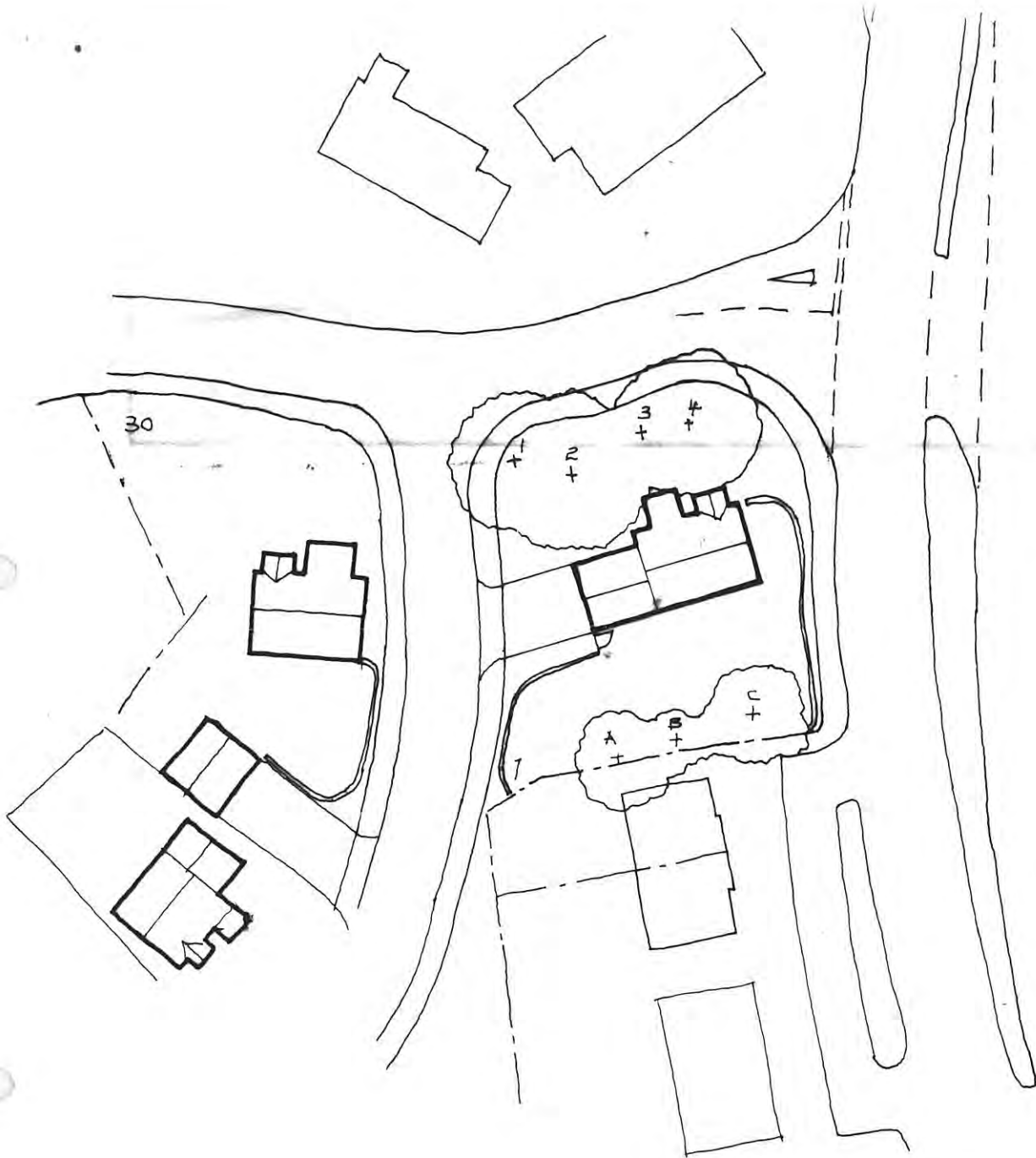

TREES

- 1 = SILVER BIRCH :- WILL BE AFFECTED BY FOUNDATIONS FOR ROAD
- 2 = SYCAMORE :- POOR CONDITION
- 3 = SILVER BIRCH
- 4 = LIME
- A = SYCAMORE
- B = HOLLY
- C = SYCAMORE

KINGHAM KNIGHT ARCHITECTS (WARRINGTON) LIMITED
 Consultant Architects to Warrington and Runcorn Development Corporation

KKA

New Town House Buttermarket Street Warrington WA1 2LF 0295 51144 Fax 0925 411493



NO.	W	3	2	3	
	S	K	1		
SCALE	1:500			REVISION	
DRAWN BY	M/D			DATE	
				FEB 1985	

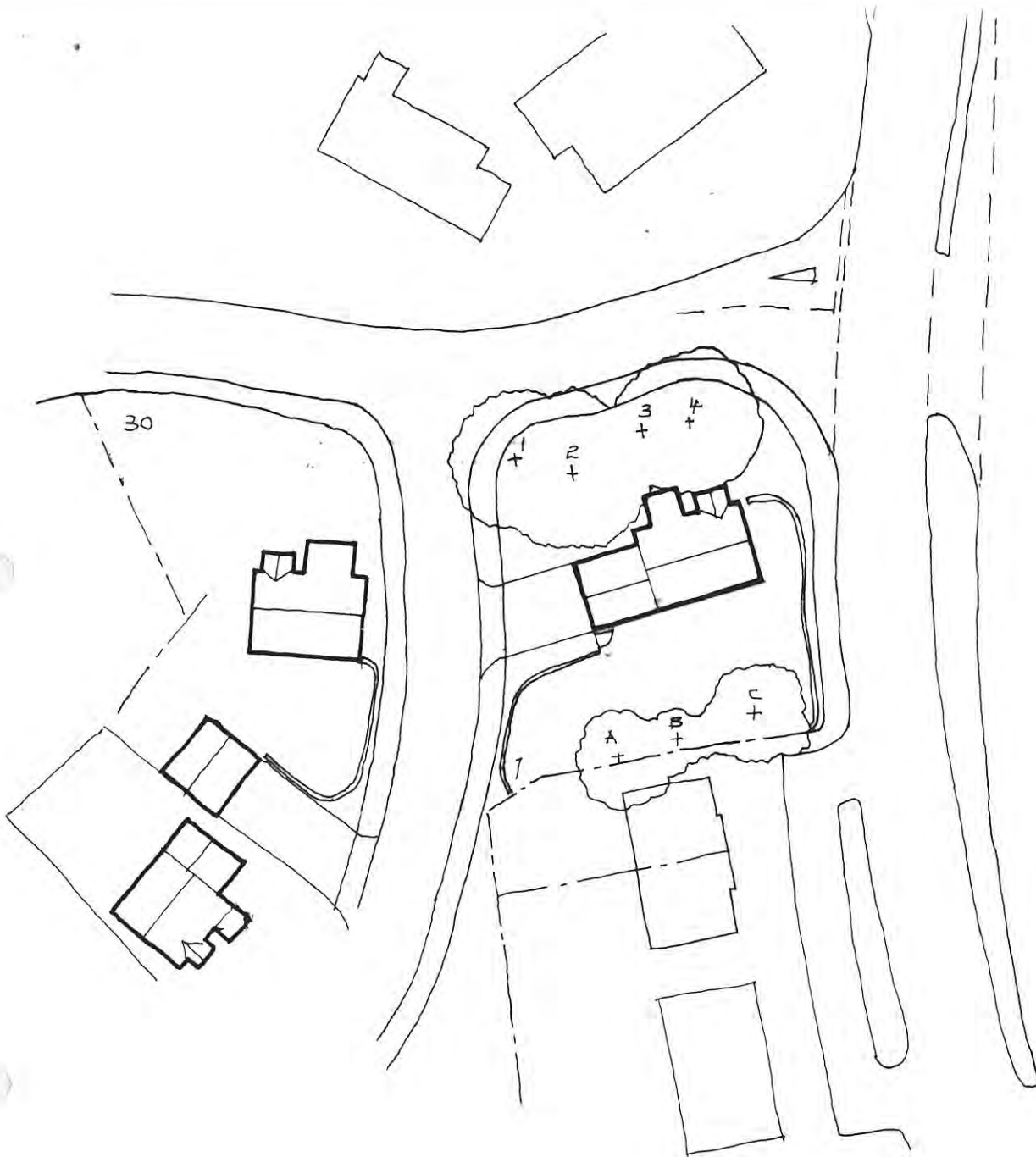

TREES

- 1 = SILVER BIRCH ; - WILL BE AFFECTED BY FOUNDATIONS FOR ROAD
- 2 = SYCAMORE ! - POOR CONDITION
- 3 = SILVER BIRCH
- 4 = LIME
- A = SYCAMORE
- B = HOLLY
- C = SYCAMORE

KINGHAM KNIGHT ARCHITECTS (WARRINGTON) LIMITED
 Consultant Architects to Warrington and Runcorn Development Corporation



New Town House Buttermarket Street Warrington WA1 2LF 0295 51144 Fax 0925 411493

NO.	W	3	2	3	
	S	K	J		
SCALE	1:500			REVISION	
DRAWN BY	MWD			DATE FEB 1989	

WARRINGTON BOROUGH COUNCIL
TOWN & COUNTRY PLANNING ACTS 1971-1974

THE WARRINGTON BOROUGH COUNCIL (LAND ADJOINING WARRINGTON
ROAD AND GRANGE DRIVE, PENKETH) TREE PRESERVATION ORDER 1989

NOTICE PURSUANT TO REGULATION 5 (c) OF THE TOWN AND COUNTRY PLANNING
(TREE PRESERVATION ORDER) REGULATIONS 1969

TO: HILLCREST HOMES
HILLCREST
KNUTSFORD ROAD
WARRINGTON

TAKE NOTICE that the Council has sealed the above Order which has been made on the following grounds : The site is prominently located at the junction of Warrington Road and Grange Drive the two groups of trees enhance the visual amenity of the area and are in danger of being lost as a result of pressures for residential development.

Certified copies of the Order and the Map referred to therein have been deposited at the Town Hall, Warrington and may be inspected there between the hours of 9.00 am and 5.30 pm Monday to Thursday and 4.30 pm on Friday, and any objections and representations may be made to the Borough Secretary at the Town Hall, Warrington Cheshire in accordance with the following requirements:-

- (a) every objection or representation with respect to this Order shall be made in writing to the Borough Secretary and shall state the grounds thereof and specify the particular trees, groups of trees or woodlands in respect of which it is made
- (b) an objection or representation shall be duly made if it complies with (a) above and is received by the Borough Secretary within 28 days from the date of the service of the Notice of the making of the Order

If no objections or representations are duly made or any so made are withdrawn, then not less than forty two days from the date of service of the Notice of the making of the Order, the Order will be confirmed by the Council as an unopposed Order.

The Council has included in the Order a direction to the effect that Section 61 of the Town and Country Planning Act 1971 shall apply thereto. Under Section 61 the Order takes effect provisionally on the date stated therein and continues in force either for six months or until confirmation if confirmed within the six months period. The date stated in the Order for taking effect is 23 February 19 89 and from that date actions described in the Order as contraventions thereof become offences in the manner likewise described.

Dated this 23rd day of February 1989

Borough Secretary

PLANS SUB COMMITTEE

4 JANUARY 1989

REPORT OF THE PLANNING AND ESTATES OFFICER

PROPOSED TREE PRESERVATION ORDER - WARRINGTON ROAD/GRANGE DRIVE, PENKETH

INTRODUCTION

An application for planning consent has been received for the development of land to the south of Warrington Road, Penketh for 25 houses. Several trees are located close to the frontage of the site with Warrington Road and Grange Drive and these are not currently protected by a Tree Preservation Order.

POLICY BACKGROUND

The site of 2.24 hectares is bounded by the Whittle Brook to the east. The site was identified as Open Space in the Warrington New Town Structure Map as part of the Whittle Brook Linear Park. It is however unlikely that the W&RDC will complete the park and negotiations are currently underway between the applicants, Hillcrest Homes and the Council regarding the completion of the park as a Section 52 Agreement.

APPRAISAL

Two groups of trees lies north of the proposed entrance to the site and are visible from both Warrington Road and Grange Drive.

If permission is granted for residential development of the site, these mature trees will be incorporated into gardens of individual plots and as such may be at risk of felling.

It is recommended that authorisation be given to the making of a Tree Preservation Order for the future protection of these trees.



Warrington Borough Council. WEST ANNEXE, TOWN HALL, WA1. 1UH.
 PLANNING & ESTATES DEPARTMENT. Tel: Warr 444400

PLANNING & ESTATES OFFICER. M.I.M. Sanders, BSc, Dip TP, FRGS, MRTPI.

TITLE. The Warrington Borough Council (Warrington Road / Grange Drive. Penketh.)
 Tree Preservation Order. 1999

PROJECT.

DATE. 29-11-99	SCALE. 1-1250	DRAWING NO.	DRAWN BY.	APPROVED BY.	REVISION.
-------------------	------------------	-------------	-----------	--------------	-----------

FIRST SCHEDULE

TREES SPECIFIED INDIVIDUALLY

None

TREES SPECIFIED BY REFERENCE TO AN AREA

None

GROUPS OF TREES

(Within a broken black line on the map)

NO. ON MAP

DESCRIPTION

SITUATION

G1

Group of 2 sycamore
and 1 holly

Adj. the boundary of
52 Warrington Road.

G2

Group of 1 silver birch
1 lime and 1 sycamore

On the corner of
Grange Drive and
Warrington Road

WOODLANDS

None

GS/KMB
25th November 1988



THE WARRINGTON BOROUGH COUNCIL
 WARRINGTON ROAD/GRANGE DRIVE, PENKETH
 TREE PRESERVATION ORDER 2000



Name	
Dept.	Community Services
Ref.	
Date	9/3/2000
Scale	1:1,250

This map is reproduced from Ordnance Survey material with the permission of Ordnance Survey on behalf of the Controller of HMSO © Crown copyright. Unauthorised reproduction infringes Crown copyright & may lead to prosecution or civil proceedings. Warrington B.C. LA079898. Published.....



THE WARRINGTON BOROUGH COUNCIL
 WARRINGTON ROAD/GRANGE DRIVE, PENKETH
 TREE PRESERVATION ORDER 2000



Name	
Dept.	Community Services
Ref.	
Date	9/3/2000
Scale	1:1,250

This map is reproduced from Ordnance Survey material with the permission of Ordnance Survey on behalf of the Controller of HMSO © Crown copyright. Unauthorised reproduction infringes Crown copyright & may lead to prosecution or civil proceedings. Warrington B.C. LA079898. Published.....



THE WARRINGTON BOROUGH COUNCIL
 WARRINGTON ROAD/GRANGE DRIVE, PENKETH
 TREE PRESERVATION ORDER 2000



Name
 Dept. Community Services
 Ref.
 Date 9/3/2000
 Scale 1:1,250

This map is reproduced from Ordnance Survey material with the permission of Ordnance Survey on behalf of the Controller of HMSO © Crown copyright. Unauthorised reproduction infringes Crown copyright & may lead to prosecution or civil proceedings. Warrington B.C. LA079898. Published.....



THE WARRINGTON BOROUGH COUNCIL
 WARRINGTON ROAD/GRANGE DRIVE, PENKETH
 TREE PRESERVATION ORDER 2000



Name
 Dept. Community Services
 Ref.
 Date 9/3/2000
 Scale 1:1,250

This map is reproduced from Ordnance Survey material with the permission of Ordnance Survey on behalf of the Controller of HMSO © Crown copyright. Unauthorised reproduction infringes Crown copyright & may lead to prosecution or civil proceedings. Warrington B.C. LA079898. Published.....

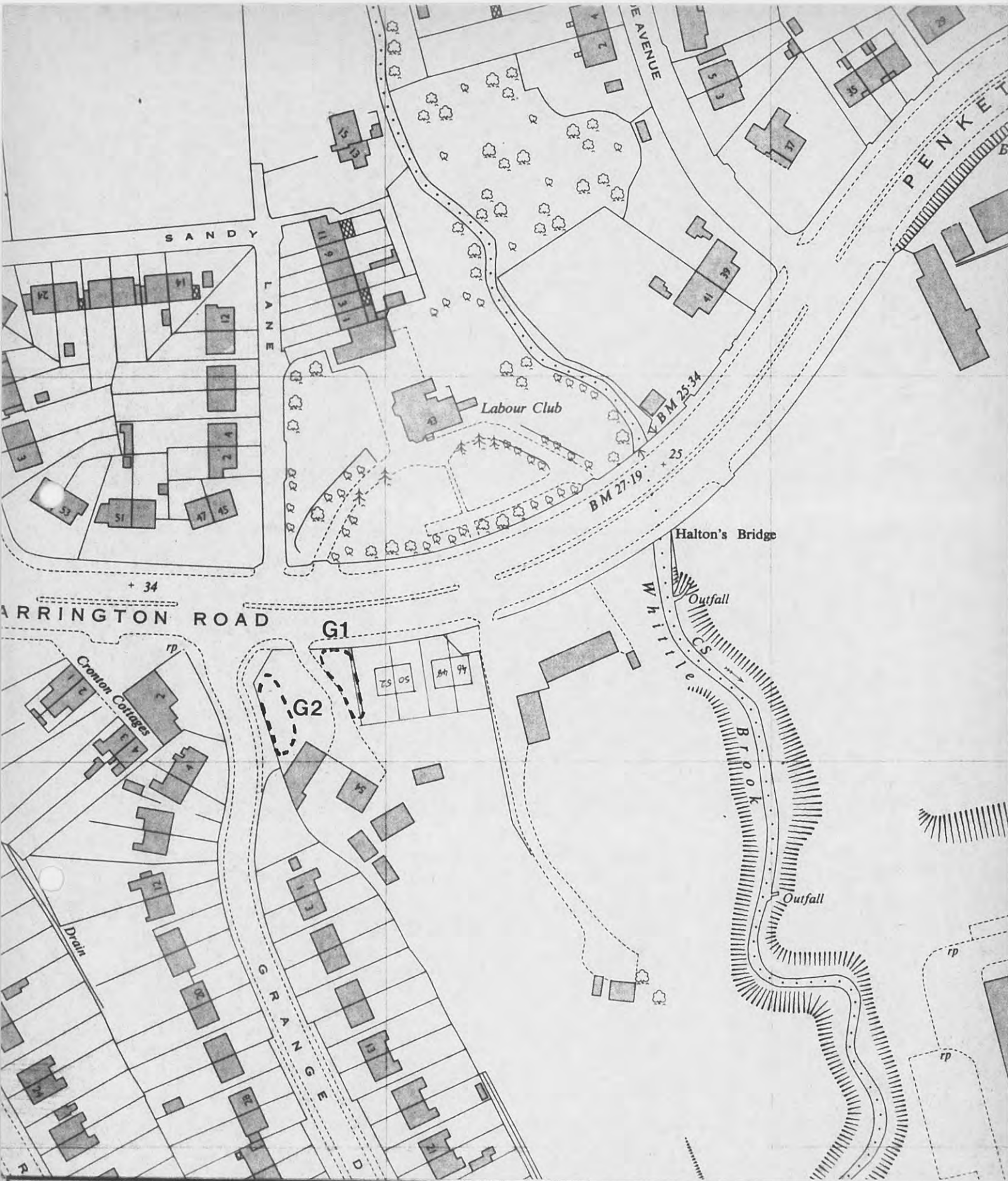

Warrington Borough Council. WEST ANNEXE, TOWN HALL, WA1. 1UH.
 PLANNING & ESTATES DEPARTMENT. Tel: Warr 444400

PLANNING & ESTATES OFFICER. M.I.M. Sanders, BSc, Dip TP, FRGS, MRTPI.

TITLE. The Warrington Borough Council (Warrington Road / Grange Drive. Penketh.)
 Tree Preservation Order. 1999

PROJECT.

DATE. 29-11-99	SCALE. 1-1250	DRAWING N ^o .	DRAWN BY.	APPROVED BY.	REVISION.
-------------------	------------------	--------------------------	-----------	--------------	-----------

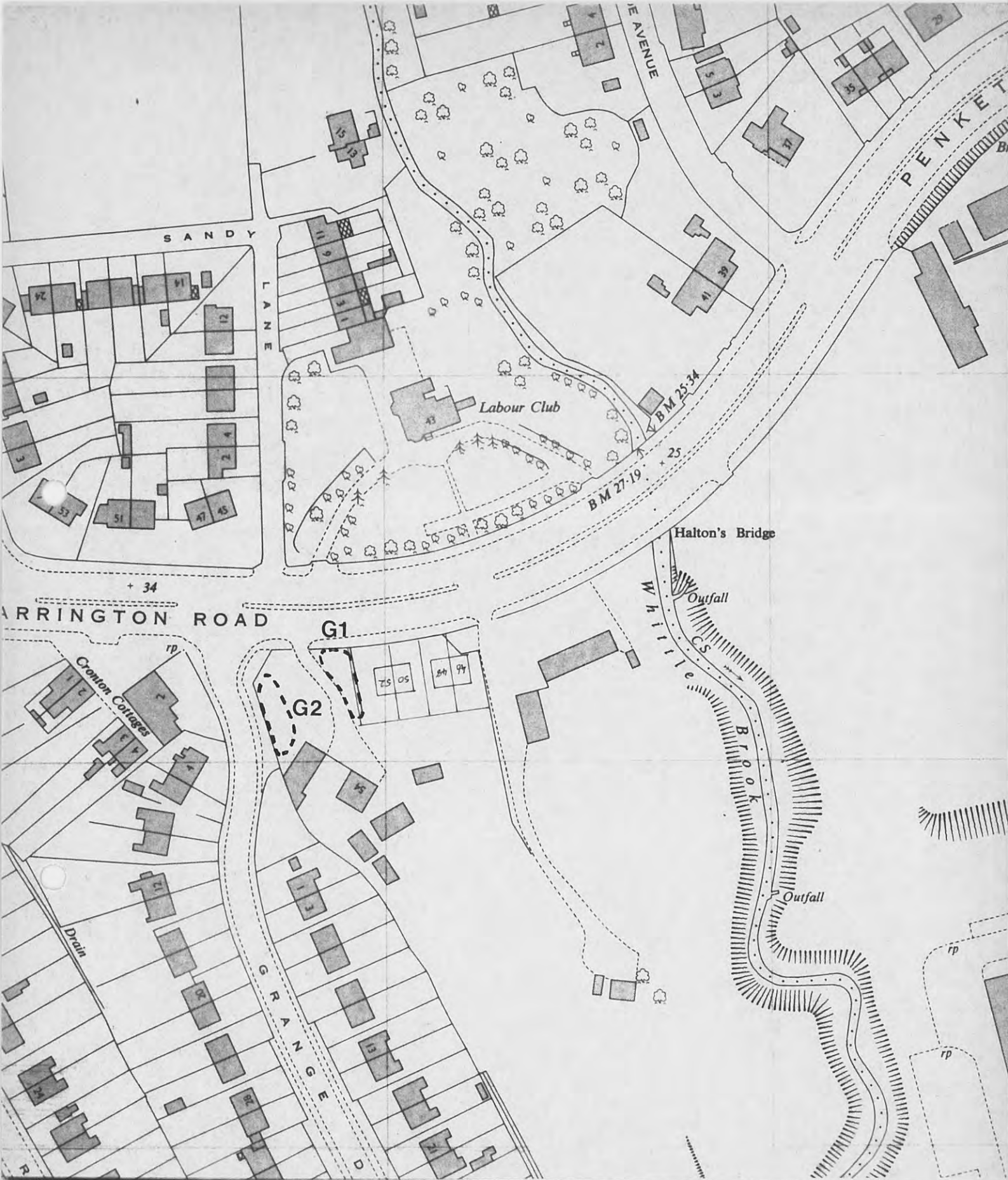

Warrington Borough Council. WEST ANNEXE, TOWN HALL, WA1. 1UH. PLANNING & ESTATES DEPARTMENT. Tel: Warr 444400

PLANNING & ESTATES OFFICER. M.I.M. Sanders, BSc, Dip TP, FRGS, MRTPI.

TITLE. The Warrington Borough Council (Warrington Road / Grange Drive. Penketh.)
Tree Preservation Order. 1999

PROJECT.

DATE. 29-11-99	SCALE. 1-1250	DRAWING N ^o .	DRAWN BY.	APPROVED BY.	REVISION.
-------------------	------------------	--------------------------	-----------	--------------	-----------

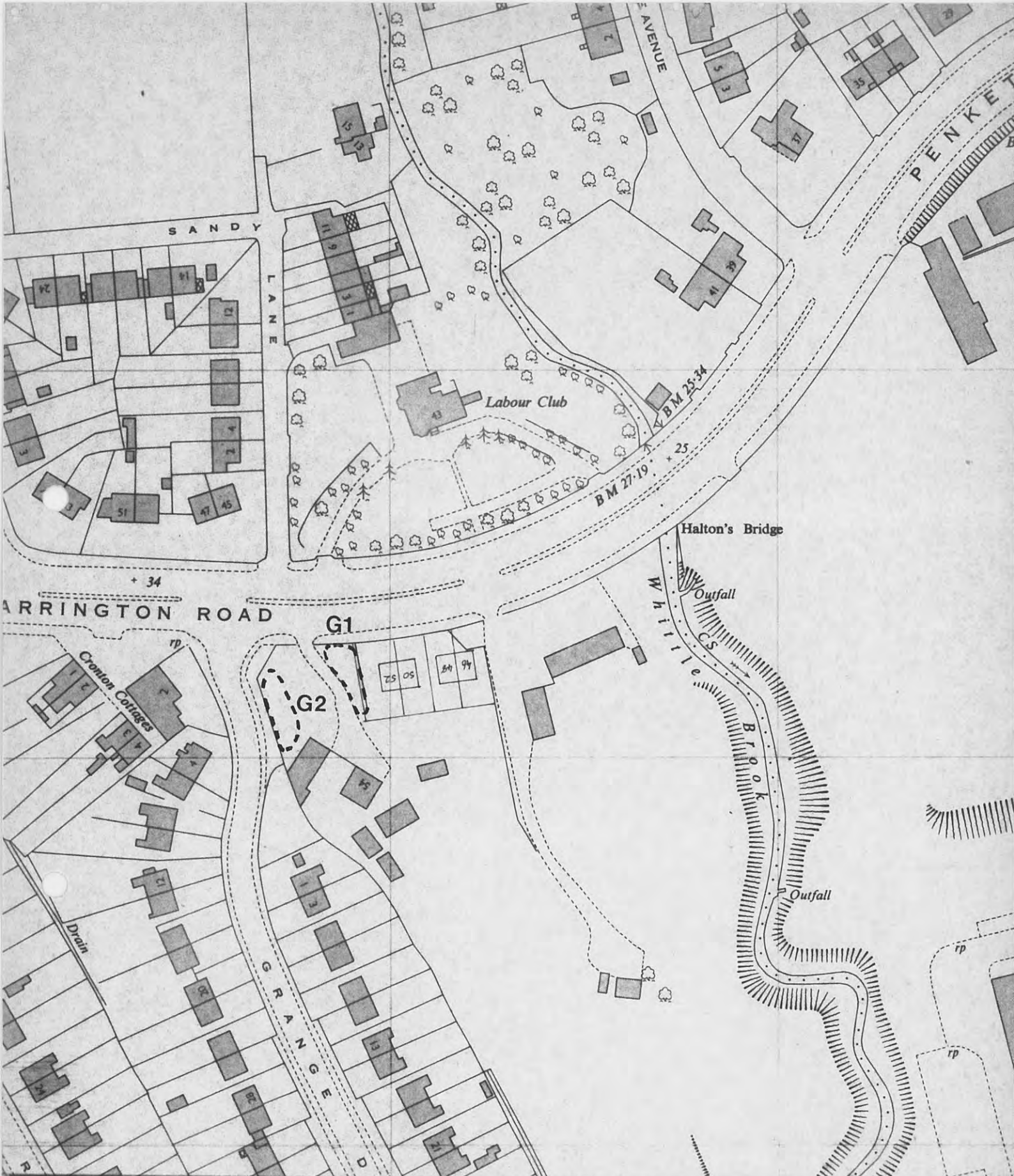

Warrington Borough Council. WEST ANNEXE, TOWN HALL, WA1. 1UH.
 PLANNING & ESTATES DEPARTMENT. Tel: Warr 444400

PLANNING & ESTATES OFFICER. M.I.M. Sanders, BSc, Dip TP, FRGS, MRTPI.

TITLE. The Warrington Borough Council (Warrington Road / Grange Drive. Penketh.)
 Tree Preservation Order. 1999

PROJECT.

DATE. 29-11-99	SCALE. 1-1250	DRAWING N ^o .	DRAWN BY.	APPROVED BY.	REVISION.
-------------------	------------------	--------------------------	-----------	--------------	-----------

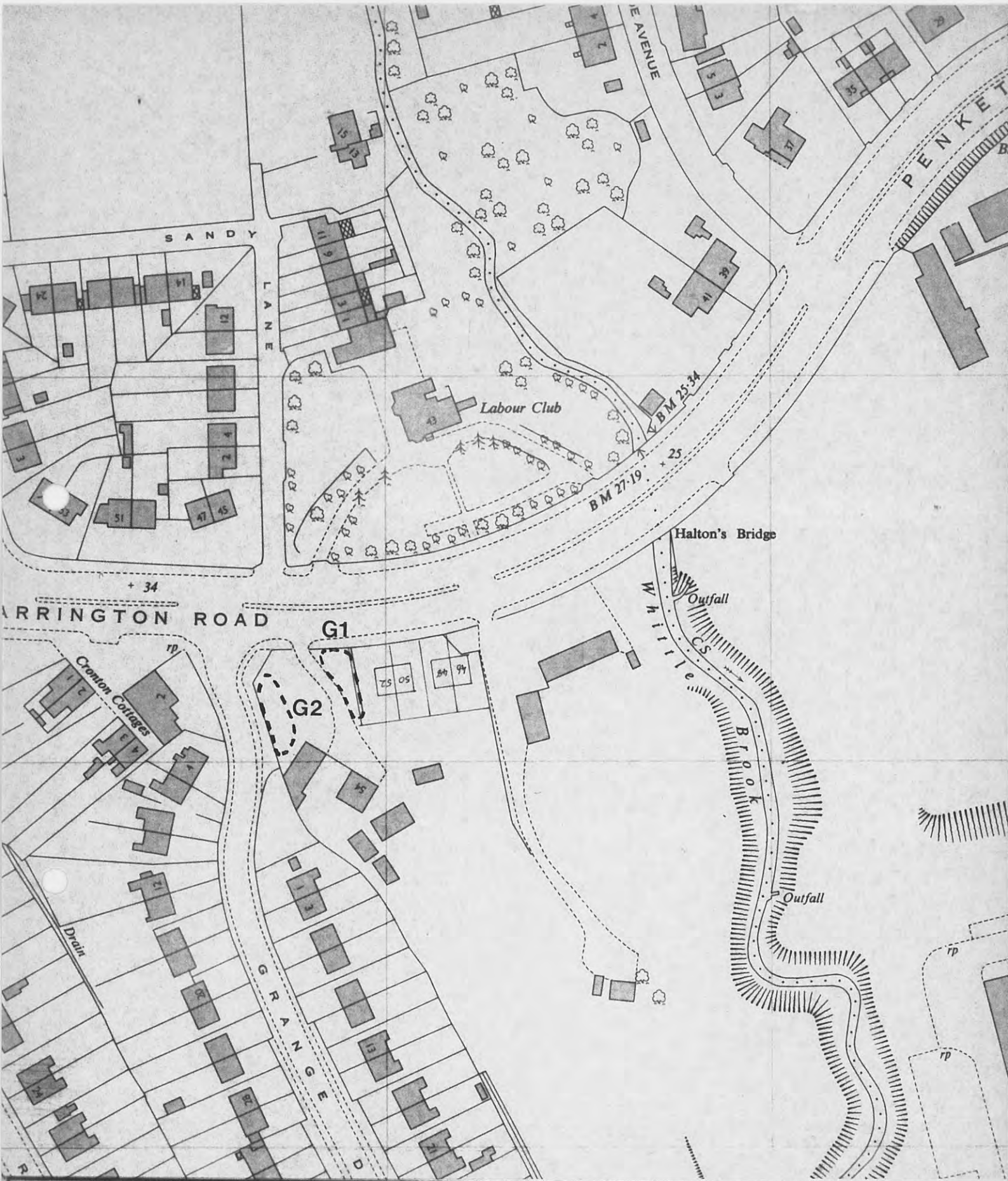

Warrington Borough Council. WEST ANNEXE, TOWN HALL, WA1. 1UH.
 PLANNING & ESTATES DEPARTMENT. Tel: Warr 444400

PLANNING & ESTATES OFFICER. M.I.M. Sanders, BSc, Dip TP, FRGS, MRTPI.

TITLE. The Warrington Borough Council (Warrington Road / Grange Drive. Penketh.)
 Tree Preservation Order. 1999

PROJECT.

DATE. 29-11-99	SCALE. 1-1250	DRAWING N ^o .	DRAWN BY.	APPROVED BY.	REVISION.
-------------------	------------------	--------------------------	-----------	--------------	-----------

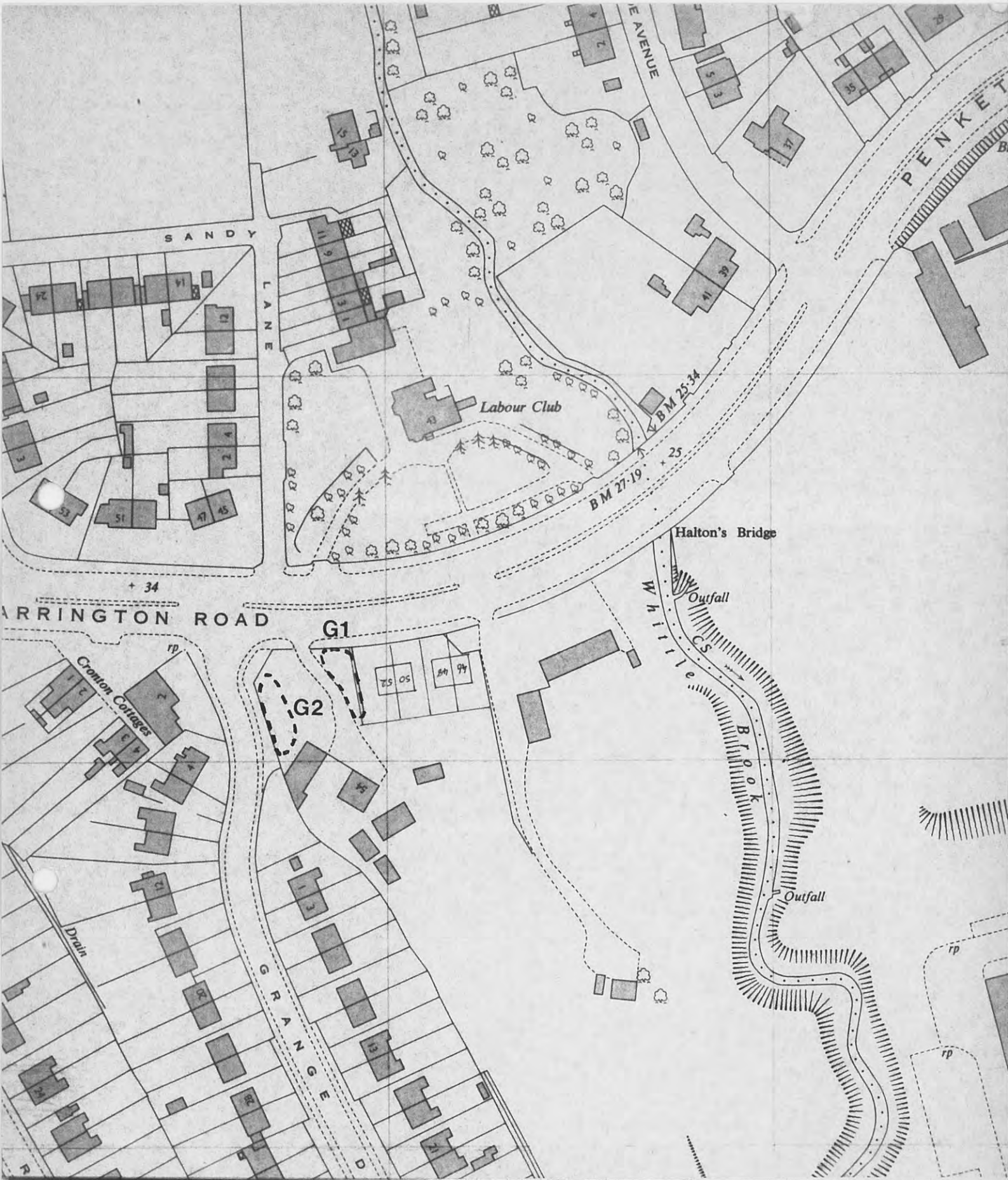

Warrington Borough Council. WEST ANNEXE, TOWN HALL, WA1. 1UH.
 PLANNING & ESTATES DEPARTMENT. Tel: Warr 444400

PLANNING & ESTATES OFFICER. M.I.M. Sanders, BSc, Dip TP, FRGS, MRTPI.

TITLE. The Warrington Borough Council (Warrington Road / Grange Drive. Penketh.)
 Tree Preservation Order. 1999

PROJECT.

DATE. 29-11-99	SCALE. 1-1250	DRAWING No.	DRAWN BY.	APPROVED BY.	REVISION.
-------------------	------------------	-------------	-----------	--------------	-----------

WARRINGTON BOROUGH COUNCIL
TOWN AND COUNTRY PLANNING ACT 1990
VARIATION ORDER

**THE WARRINGTON BOROUGH COUNCIL (LAND ADJOINING WARRINGTON
ROAD AND GRANGE DRIVE PENKETH)**
TREE PRESERVATION ORDER 1989

The **WARRINGTON BOROUGH COUNCIL** ("the Authority") did on 23rd February 1989 make the above Tree Preservation Order ("the Order") pursuant to Section 198 and Section 201 of the Town and Country Planning Act 1990 ("the Act") the Order being subsequently confirmed by the Authority without modification on 9th August 1989.

The Authority now hereby varies the Order as shown in Schedule 1, which shall now be designated as The Warrington Borough Council (Land Adjoining Warrington Road and Grange Drive Penketh) Tree Preservation Order 2000.

Dated this 27th day of April 2000

The Common Seal of **WARRINGTON
BOROUGH COUNCIL** was hereunto
affixed in the presence of:-

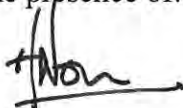

Solicitor to the Council

FIRST SCHEDULE

Trees Specified Individually (encircled in black on the map)

NO. ON MAP	DESCRIPTION	SITUATION
T1	Sycamore	Adjacent to the boundary of 52 Warrington Road

Area

None

Groups of Trees (within a broken black line on the map)

NO. ON MAP	DESCRIPTION	SITUATION
G1	Group of 1 Silver Birch, 1 Lime and 1 Sycamore	On the corner of Grange Drive and Warrington Road

Woodlands

None



THE WARRINGTON BOROUGH COUNCIL
 WARRINGTON ROAD/GRANGE DRIVE, PENKETH
 TREE PRESERVATION ORDER 2000



Name
 Dept. Community Services
 Ref.
 Date 9/3/2000
 Scale 1:1,250

This map is reproduced from Ordnance Survey material with the permission of Ordnance Survey on behalf of the Controller of HMSO © Crown copyright. Unauthorised reproduction infringes Crown copyright & may lead to prosecution or civil proceedings. Warrington B.C. LA079898. Published.....