

This Order was confirmed by the Warrington Borough Council without modification on the 15th August 2014.

A. Dale
.....
Authorised by the Council to sign in that behalf.

**PUBLIC PATH DIVERSION
HIGHWAYS ACT 1980 SECTION 119**

**WARRINGTON BOROUGH COUNCIL
GRAPPENHALL & THELWALL FOOTHPATH No 13 (part)
PUBLIC PATH DIVERSION ORDER 2014**

This Order is made by Warrington Borough Council ("the authority") under section 119 of the Highways Act 1980 ("the 1980 Act") because it appears to the authority that in the interests of the owner of the land it is expedient that the line of the path should be diverted.

Grappenhall & Thelwall Parish Council has been consulted as required by section 120(2) of the 1980 Act

BY THIS ORDER:

1. The public right of way over the land situated at Grappenhall and Thelwall and shown by a bold continuous line on the map contained in this order and described in Part 1 of the Schedule to this order shall be stopped up after both notification of confirmation of this order and certification of work to provide the new length of footpath has been published.
2. There shall, at the end of 1 day after notification of both confirmation of this order and certification of work to provide the new length of footpath has been published, be a public footpath over the land situated at Grappenhall and Thelwall described in Part 2 of the Schedule and shown by a bold broken line on the map attached to this order.

SCHEDULE

PART 1

DESCRIPTION OF SITE OF EXISTING PATH OR WAY

From a point on the path 95m. from its junction with Weaste Lane at O.S. grid reference SJ6486186637 running in a south westerly direction for approximately 4m. to O.S. grid reference SJ6485786634 then north westerly for approximately 33m. to O.S. grid reference SJ6483086654 then north north easterly for approximately 52m. to O.S. grid reference SJ6485686698, A – B – C – D as indicated on the map. The width of the path is undefined.

PART 2

DESCRIPTION OF SITE OF NEW PATH OR WAY

From a point on the path approximately 95m. from its junction with Weaste Lane at O.S. grid reference SJ6486186637 running in a north westerly direction for 3m. to O.S. grid reference SJ6485986639 then north easterly for approximately 40m. to O.S. grid reference SJ6488886666 then north westerly for approximately 46m. to O.S. grid reference SJ6485686698, A – E – F – D as indicated on the map. The width of the path is 2m.

Given under the Common Seal of the Council of the Borough of Warrington this 27th day of May 2014.

The Common Seal of **WARRINGTON BOROUGH**)
COUNCIL was hereunto Affixed in the presence of: -)

Paul [Signature]
Authorised Signatory



**Grappenhall & Thelwall footpath no.13 (part)
Public Path Diversion Order 2014**

Warrington Borough Council
Environment and Regeneratio
Newtown House
Buttermarket Street
Warrington
WA1 2NH

Warrington Borough Council



Scale 1:500

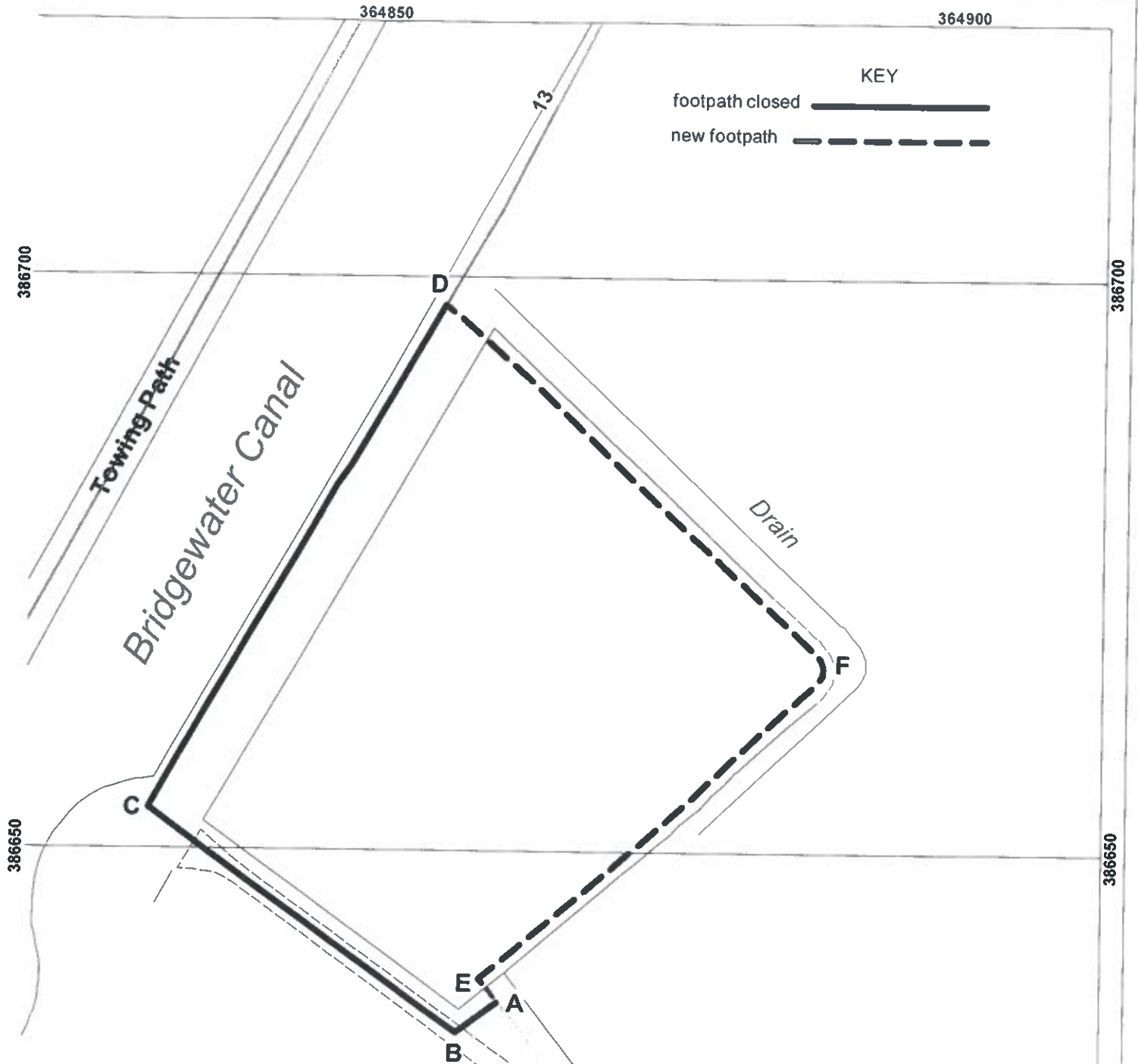

The Common Seal of Warrington Borough Council was
hereunto affixed in the presence of:

Paul [Signature]
Authorised Signatory

486934



FOR REFERENCE PURPOSES ONLY
NO FURTHER COPIES MAY BE MADE