

NOTES:
 Drawing based on Geomatic Surveys Ltd topographical survey 01532/01 dated 27/07/15.
 ©Crown copyright and database rights 2017 OS Licence 100056454.

ISSUE	REASON FOR REVISION	DATE

PROJECT:	PEEL HALL, WARRINGTON	
CLIENT:	SATNAM MILLENNIUM LTD	
PROJECT REFERENCE:	DRAWING NUMBER:	SCALE:
1107	08/P	1:500 @ A3

HighgateTransportation
www.highgatetransportation.co.uk
 First Floor, 43-45 Park Street
 Bristol BS1 5NL
 01179 349 121
 © Highgate Transportation Limited

TITLE:
**PROPOSED ACCESS TO RESIDENTIAL
 LAND AT BIRCH AVENUE**

DATE:	DRAWN BY:	CHECKED:
03/02/17	FB	DT

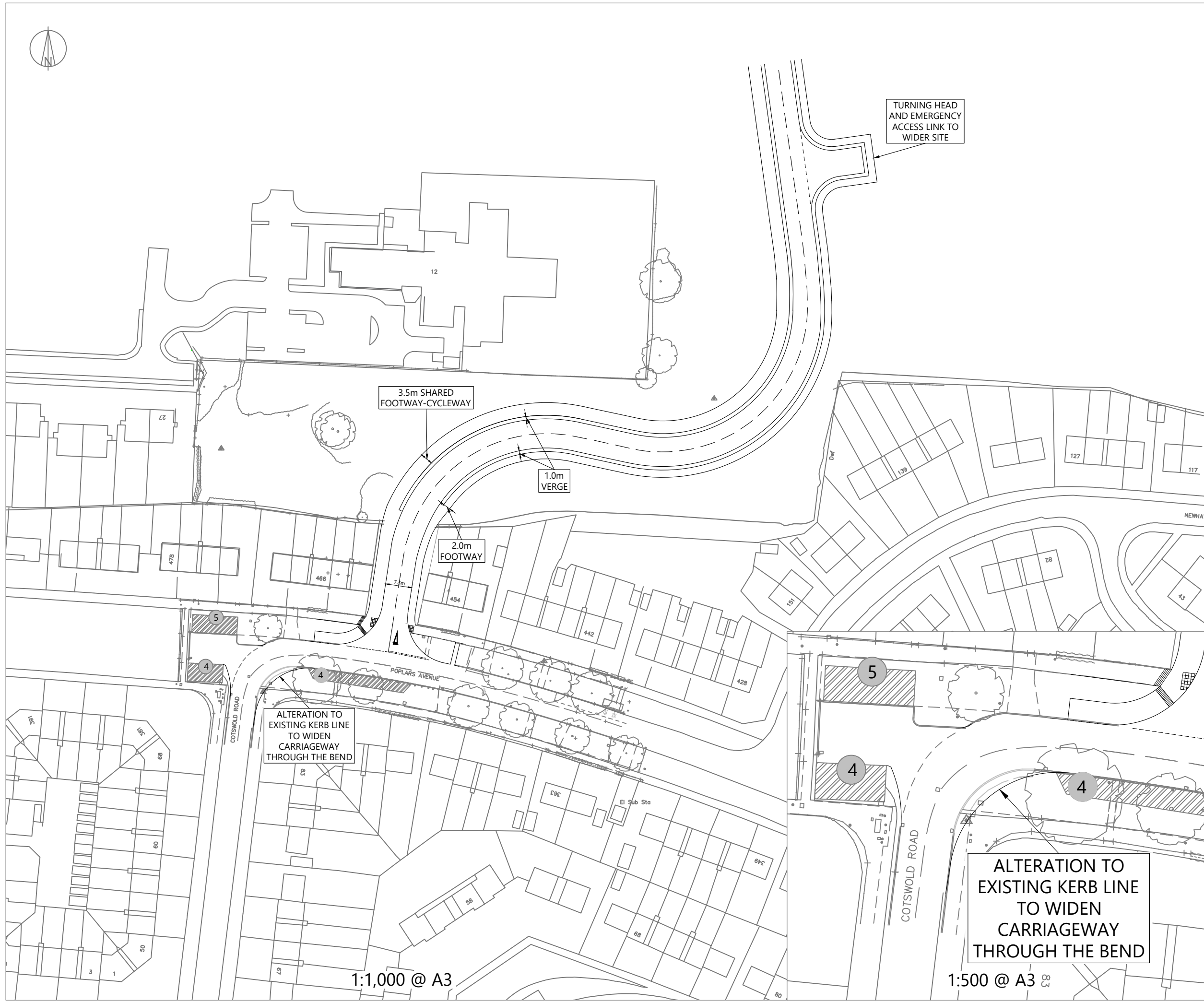

1:1,000 @ A3

1:500 @ A3

NOTES:
Drawing based on Geomatic Surveys Ltd topographical survey 01532/01 dated 27/07/15.

©Crown copyright and database rights 2017 OS Licence 100056454.

KEY:

Parking Areas (number of cars that can be accommodated) **6**

ISSUE	REASON FOR REVISION	DATE

PROJECT:	PEEL HALL, WARRINGTON	
CLIENT:	SATNAM MILLENNIUM LTD	
PROJECT REFERENCE:	DRAWING NUMBER:	SCALE:
1107	09/M	AS SHOWN

Highgate*Transportation*
www.highgatetransportation.co.uk
 First Floor, 43-45 Park Street
 Bristol BS1 5NL
 01179 349 121
 © Highgate Transportation Limited

TITLE: PROPOSED ACCESS TO EMPLOYMENT LAND AT POPLARS AVENUE		
DATE:	DRAWN BY:	CHECKED:
03/02/17	FB	DT

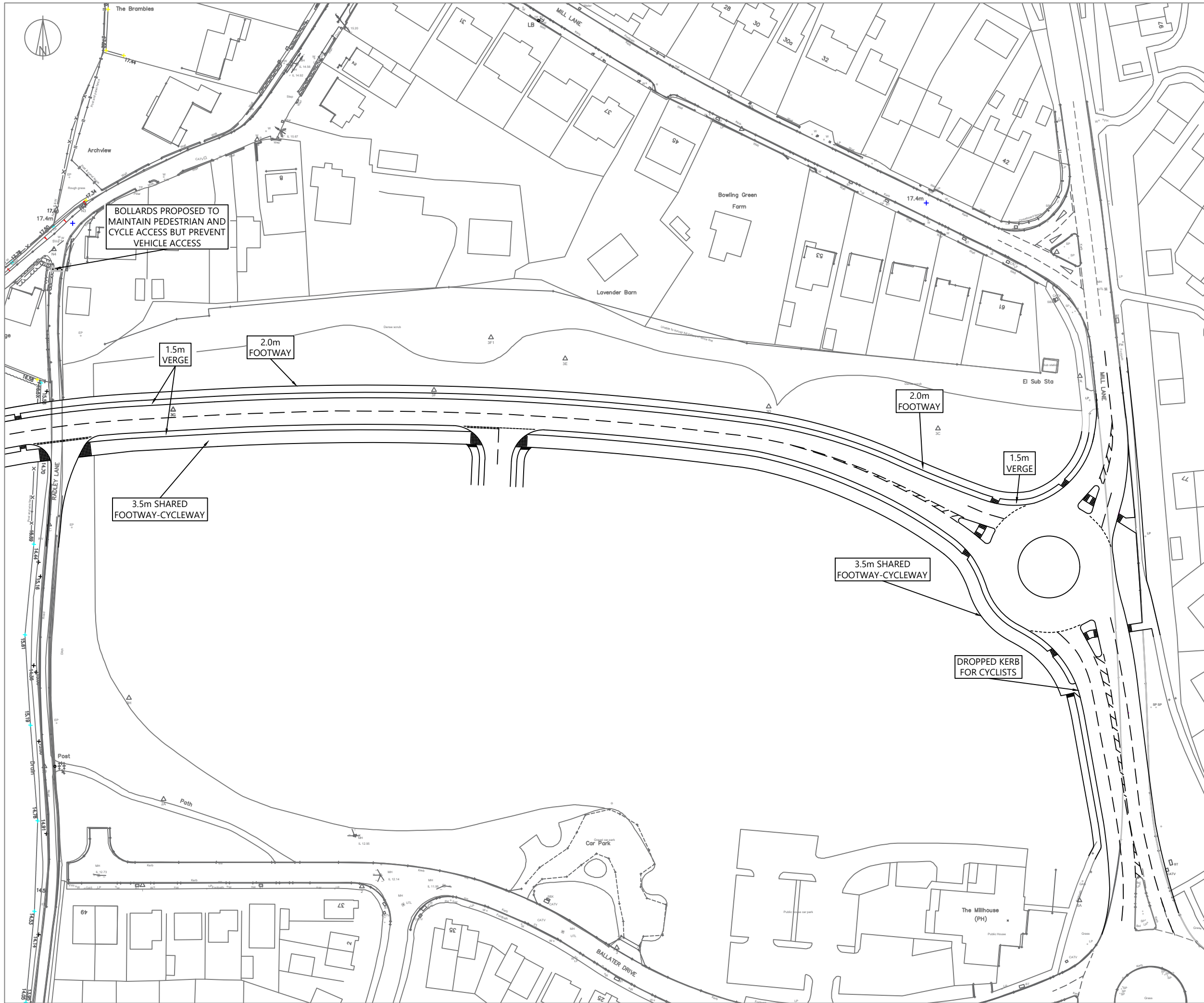

NOTES:
 Drawing based on Powers & Tiltman topographical survey 6297/01 dated 25/07/11 and Geomatic Surveys Ltd topographical survey 01532/01 dated 27/07/15.

©Crown copyright and database rights 2017 OS Licence 100056454.

ISSUE	REASON FOR REVISION	DATE

PROJECT:
**PEEL HALL,
 WARRINGTON**

CLIENT:
**SATNAM MILLENNIUM
 LTD**

PROJECT REFERENCE:	DRAWING NUMBER:	SCALE:
1107	10/N	1:1,000 @ A3

Highgate*Transportation*
www.highgatetransportation.co.uk
 First Floor, 43-45 Park Street
 Bristol BS1 5NL
 01179 349 121
 © Highgate Transportation Limited

TITLE:
**PROPOSED MAIN SITE ACCESS AT
 BLACKBROOK AVENUE**

DATE:	DRAWN BY:	CHECKED:
17/01/18	FB	DT

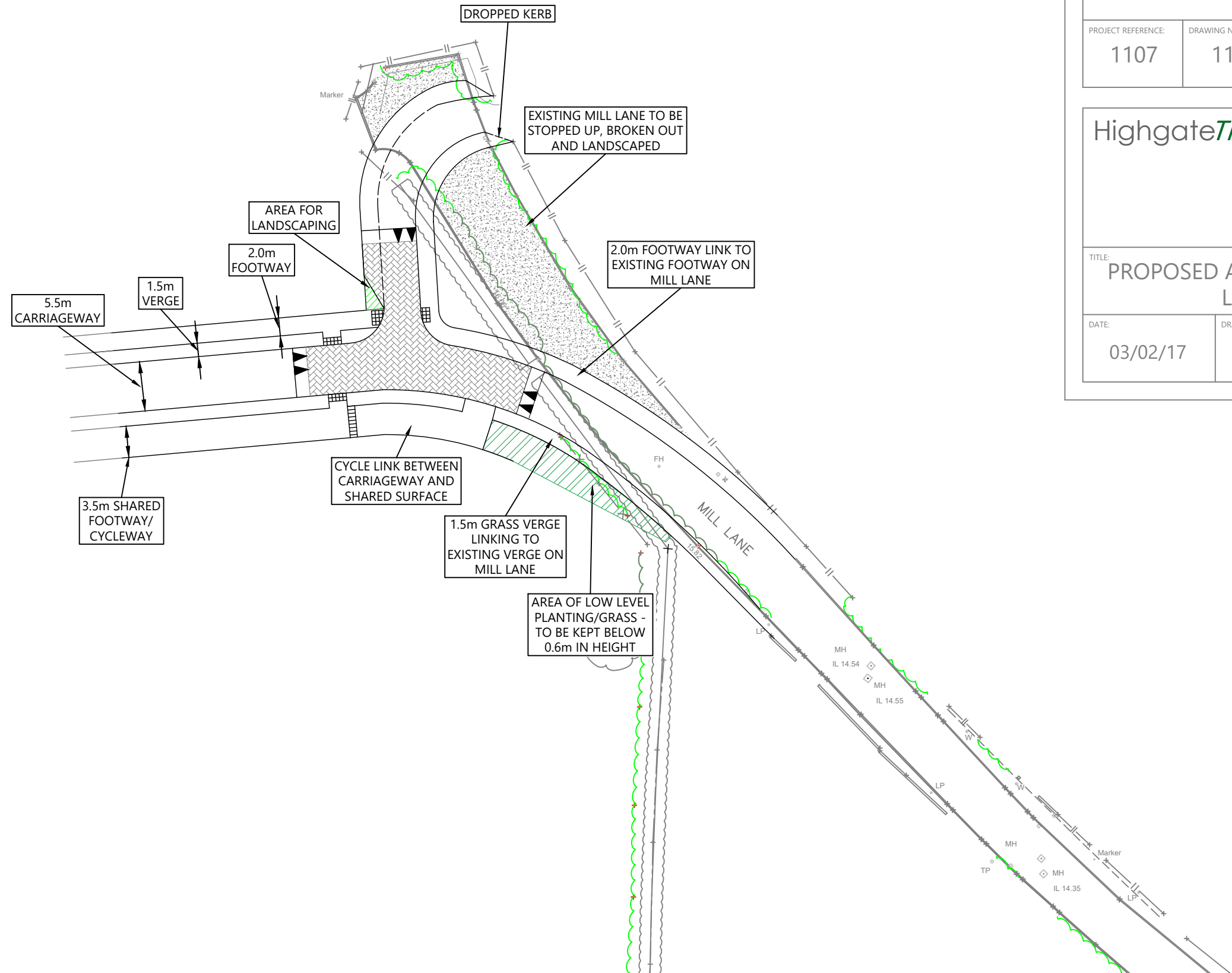

Drawing based on Powers & Tiltman
topographical survey 6297_01 dated
25/07/11.

PROJECT:

PEEL HALL,
WARRINGTON

CLIENT:

SATNAM MILLENNIUM
LTD

PROJECT REFERENCE:

1107

DRAWING NUMBER:

11/L

SCALE:

1:500 @A3

Highgate*Transportation*

www.highgatetransportation.co.uk

First Floor, 43-45 Park Street
Bristol BS1 5NL
01179 349 121

© Highgate Transportation Limited

TITLE:

PROPOSED ACCESS AT MILL
LANE

DATE:

03/02/17

DRAWN BY:

BL

CHECKED:

DT

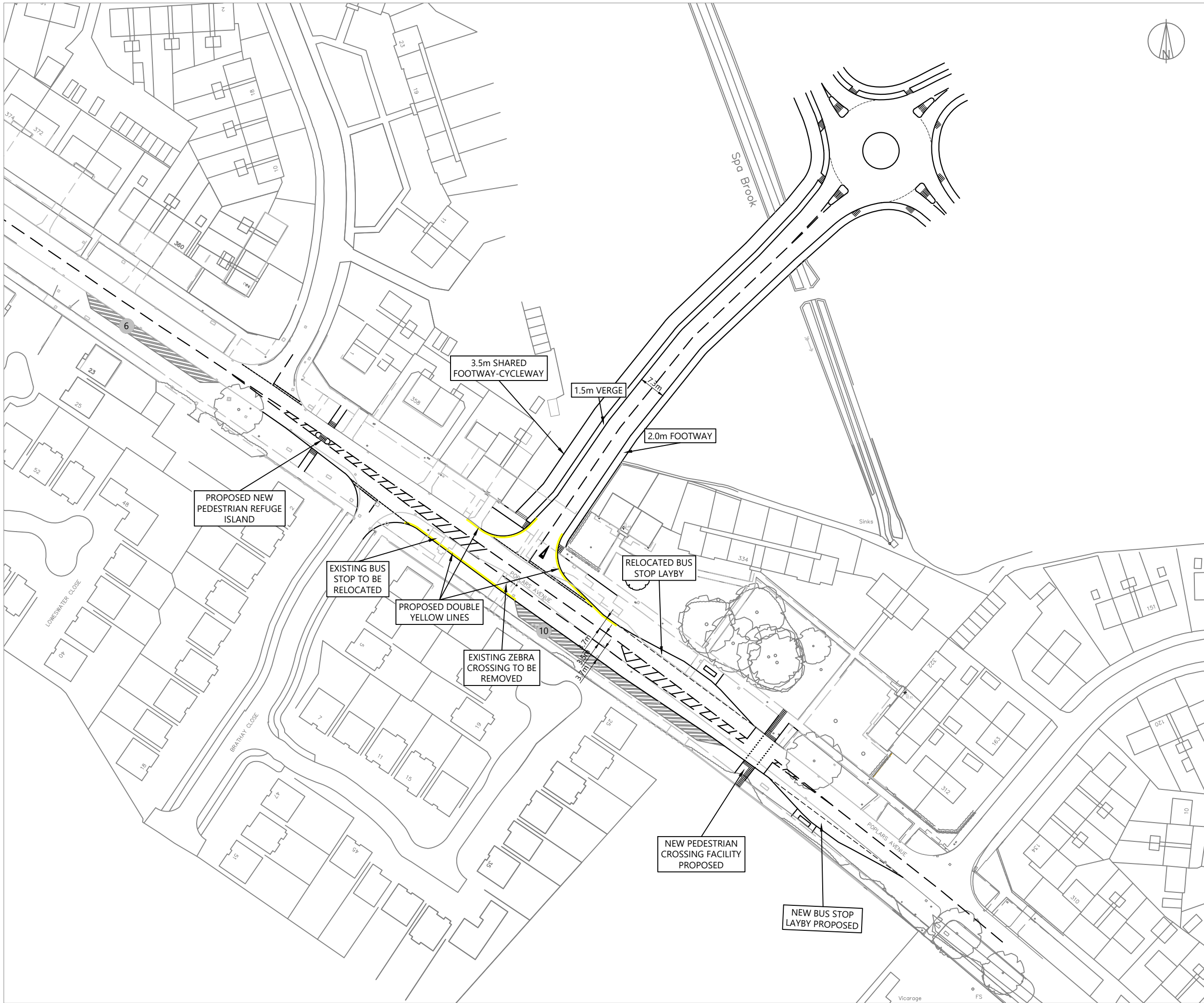

NOTES:
 Drawing based on Appletons plan 140367-B-001G dated January 2016.
 ©Crown copyright and database rights 2017 OS Licence 100056454.
 KEY:
 Parking Areas (number of cars that can be accommodated) **6**

ISSUE	REASON FOR REVISION	DATE

PROJECT:
**PEEL HALL,
 WARRINGTON**

CLIENT:
**SATNAM MILLENNIUM
 LTD**

PROJECT REFERENCE:	DRAWING NUMBER:	SCALE:
1107	12/Q	1:1,000 @ A3

HighgateTransportation
www.highgatetransportation.co.uk
 First Floor, 43-45 Park Street
 Bristol BS1 5NL
 01179 349 121
 © Highgate Transportation Limited

TITLE:
**PROPOSED ACCESS FROM POPLARS AVENUE
 TO RESIDENTIAL LAND AND LOCAL CENTRE**

DATE:	DRAWN BY:	CHECKED:
03/02/17	FB	DT



NOTES:
 Drawing based on Geomatic Surveys Ltd topographical survey 01532/01 dated 27/07/15.
 ©Crown copyright and database rights 2017 OS Licence 100056454.

ISSUE	REASON FOR REVISION	DATE

PROJECT:
**PEEL HALL,
 WARRINGTON**

CLIENT:
**SATNAM MILLENNIUM
 LTD**

PROJECT REFERENCE: 1107	DRAWING NUMBER: 30/H	SCALE: 1:500 @ A3
-----------------------------------	--------------------------------	-----------------------------

HighgateTransportation
www.highgatetransportation.co.uk
 First Floor, 43-45 Park Street
 Park Street, Bristol BS1 5NL
 01179 349 121
 © Highgate Transportation Limited

TITLE:
**PROPOSED ALTERATIONS TO EXISTING
 ACCESS AT GRASMERE AVENUE**

DATE: 15/01/18	DRAWN BY: BL	CHECKED: FB
--------------------------	------------------------	-----------------------