

NOTES:
Drawing based on Geomatic Surveys Ltd topographical survey 01532/01 dated 27/07/15.

©Crown copyright and database rights 2015 OS Licence 100035409.

KEY:

Parking Areas (number of cars that can be accommodated) **6**

ISSUE	REASON FOR REVISION	DATE

PROJECT:
**PEEL HALL,
WARRINGTON**

CLIENT:
**SATNAM MILLENNIUM
LTD**

PROJECT REFERENCE: 1107	DRAWING NUMBER: 09/K	SCALE: 1:1,000 @ A3
-----------------------------------	--------------------------------	-------------------------------

HighgateTransportation
www.highgatetransportation.co.uk
Box 13, 42 Triangle West
Park Street, Bristol BS8 1ES
07973 375 937 / 07595 892 217
© Highgate Transportation Limited

TITLE:
**PROPOSED ACCESS TO EMPLOYMENT LAND
AT POPLARS AVENUE**

DATE: 26/05/16	DRAWN BY: FB	CHECKED: DT
--------------------------	------------------------	-----------------------

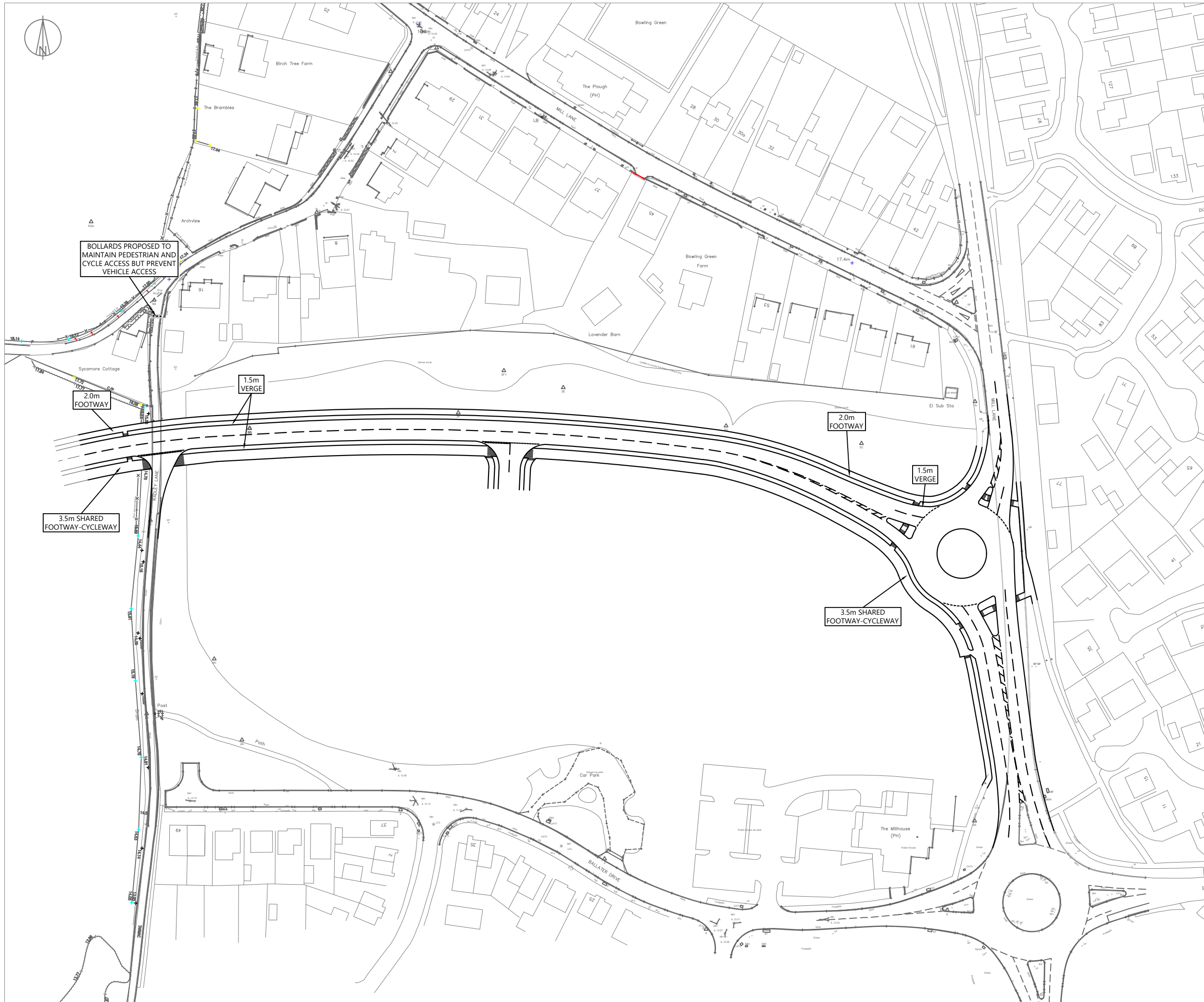

NOTES:
 Drawing based on Powers & Tiltman topographical survey 6297/01 dated 25/07/11 and Geomatic Surveys Ltd topographical survey 01532/01 dated 27/07/15.

© Crown copyright and database rights 2015 OS Licence 100035409.

ISSUE	REASON FOR REVISION	DATE

PROJECT:	PEEL HALL, WARRINGTON	
CLIENT:	SATNAM MILLENNIUM LTD	
PROJECT REFERENCE:	DRAWING NUMBER:	SCALE:
1107	10/K	1:1,250 @ A3

Highgate*Transportation*

www.highgatetransportation.co.uk

Box 13, 42 Triangle West
 Park Street, Bristol BS8 1ES
 07973 375 937 / 07595 892 217
 © Highgate Transportation Limited

TITLE: PROPOSED MAIN SITE ACCESS AT BLACKBROOK AVENUE		
DATE:	DRAWN BY:	CHECKED:
25/06/16	FB	DT

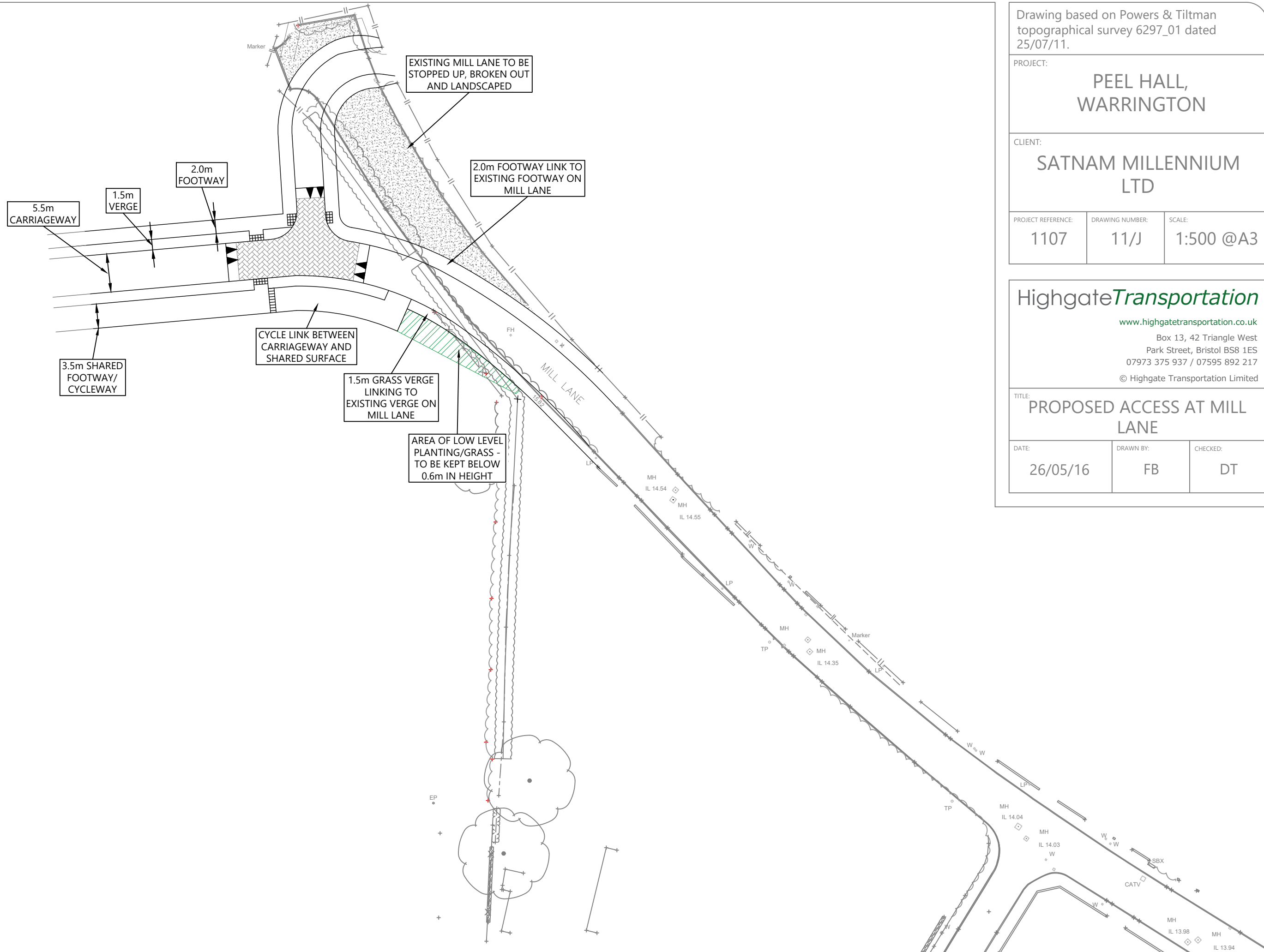

Drawing based on Powers & Tiltman
topographical survey 6297_01 dated
25/07/11.

PROJECT:

**PEEL HALL,
WARRINGTON**

CLIENT:

**SATNAM MILLENNIUM
LTD**

PROJECT REFERENCE:

1107

DRAWING NUMBER:

11/J

SCALE:

1:500 @A3

Highgate*Transportation*

www.highgatetransportation.co.uk

Box 13, 42 Triangle West
Park Street, Bristol BS8 1ES
07973 375 937 / 07595 892 217

© Highgate Transportation Limited

TITLE:

**PROPOSED ACCESS AT MILL
LANE**

DATE:

26/05/16

DRAWN BY:

FB

CHECKED:

DT

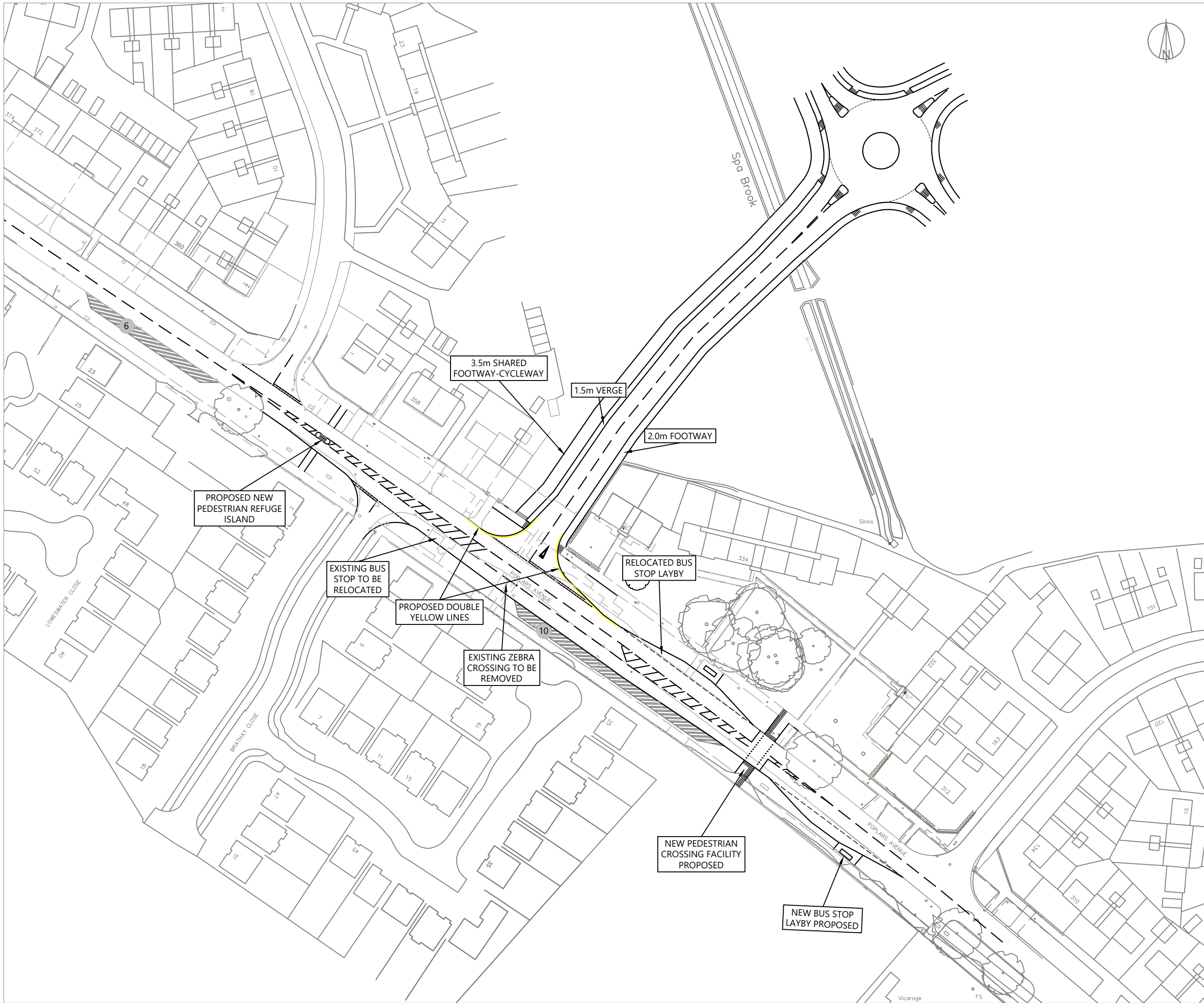

NOTES:
 Drawing based on Appletons plan 140367-B-001G dated January 2016.
 ©Crown copyright and database rights 2015 OS Licence 100035409.
 KEY:
 Parking Areas (number of cars that can be accommodated) **6**

ISSUE	REASON FOR REVISION	DATE

PROJECT:
**PEEL HALL,
 WARRINGTON**

CLIENT:
**SATNAM MILLENNIUM
 LTD**

PROJECT REFERENCE:	DRAWING NUMBER:	SCALE:
1107	12/O	1:1,000 @ A3

HighgateTransportation
www.highgatetransportation.co.uk
 Box 13, 42 Triangle West
 Park Street, Bristol BS8 1ES
 07973 375 937 / 07595 892 217
 © Highgate Transportation Limited

TITLE:
**PROPOSED ACCESS FROM POPLARS AVENUE
 TO RESIDENTIAL LAND AND LOCAL CENTRE**

DATE:	DRAWN BY:	CHECKED:
26/05/16	FB	DT



NOTES:

Drawing based on Appleton's plan Survey 2/2 drawing number 1820/02 dated January 2012.

©Crown copyright and database rights 2015 OS Licence 100035409.

ISSUE	REASON FOR REVISION	DATE

PROJECT: **PEEL HALL, WARRINGTON**

CLIENT: **SATNAM MILLENNIUM LTD**

PROJECT REFERENCE: 1107	DRAWING NUMBER: 30/E	SCALE: 1:500 @ A4
--------------------------------	-----------------------------	--------------------------

Highgate*Transportation*

www.highgatetransportation.co.uk

Box 13, 42 Triangle West
 Park Street, Bristol BS8 1ES
 07973 375 937 / 07595 892 217

© Highgate Transportation Limited

TITLE: **PROPOSED ACCESS TO SPORTS FACILITIES AT GRASMERE AVENUE**

DATE: 26/05/16	DRAWN BY: FB	CHECKED: DT
-----------------------	---------------------	--------------------